

SERIES K RF COAXIAL CONNECTORS



Series K millimeter wave style RF connector is developed based on series SMA. It can crossing-over with series SMA, used in air interface. Series K connector has many advantages, such as small size, light weight, high frequency and reliable connection etc.

Key performance

Characteristic Impedance : 50Ω
 Frequency range : $0 \sim 40\text{GHz}$
 Contact resistance :
 Center conductor $\leq 4.0\text{m} \Omega$
 Out conductor $\leq 2.0\text{m} \Omega$
 Insulation resistance : $\geq 3000\text{M} \Omega$
 Insulator voltage withstanding : 1000V
 VSWR : $\leq 1.05 + 0.015f(\text{GHz})$
 Connector durability : 500 cycles

Applicable spec/std : MIL-C-39012

Material

Center contacts:
 Male---brass, gold plated.
 Female---beryllium copper, gold plated
 Bodies and other metal parts:
 brass, gold plated
 Insulators: Teflon
 Crimp ferrule: copper, nickel plated.
 Gasket and seal rings: silicone rubber
 Heat-shrink tubing: thermofit plastic.

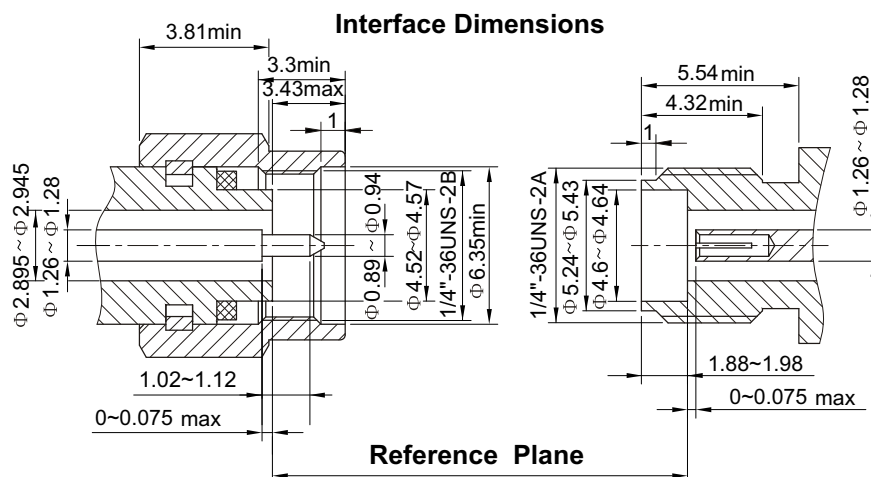

K

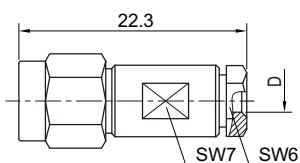

Type	part number	suitable cable	D	Note
K-JB2	2310-6601	B2	Φ 2.2	coupling nut, stainless steel
K-JB3	2310-6602	B3	Φ 3.6	coupling nut, stainless steel

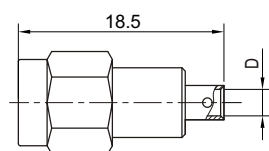

Type	part number	suitable cable	D	Note
K-JB2G	2314-6601	B2	Φ 2.4	Stainless steel body
K-JB3G	2314-6602	B3	Φ 3.6	Stainless steel body

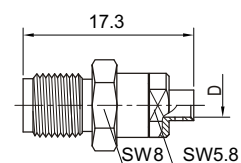

Type	part number	suitable cable	D	Note
K-KB2	2320-6601	B2	Φ 2.4	
K-KB2	2320-6603	B3	Φ 3.6	

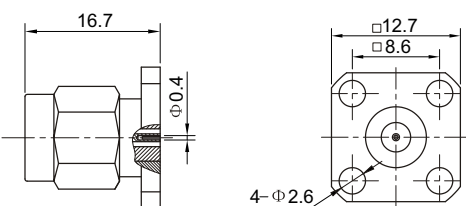
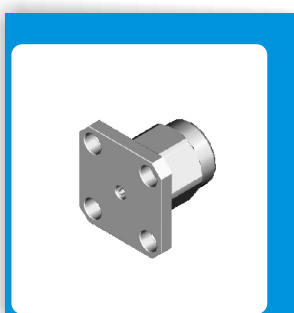

Type	part number	Note
K-JFD	2310-0001	Stainless steel body suitable pin 0.4 ^{-0.01} / _{-0.05}

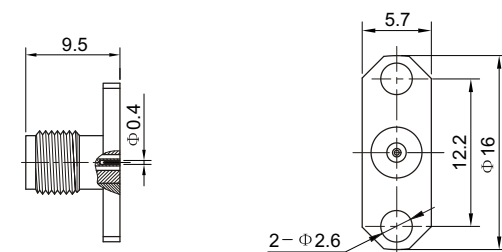

Type	part number	Note
K-KFDG	2324-0001	Stainless steel body suitable pin 0.4 ^{-0.01} / _{-0.05}